



DLA SERIES + ACCESSORIES

Stroke: 25 - 300mm
150 - 1000N

Transmotec sell a broad range of linear actuators in standard and customized configurations. Transmotec is the ideal supplier source especially to instrument and apparatus builders. We keep a high number of actuators in stock for immediate delivery.

Customizations include:

- ✓ Customized stroke length
- ✓ Customized clevis
- ✓ Customized cabling
- ✓ And more...

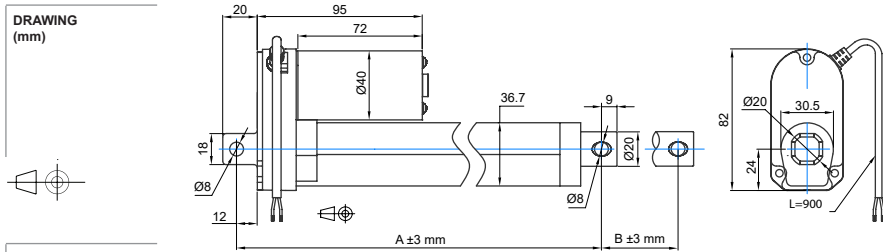

PHOTO



OPTIONS MOUNTING BRACKETS AND CONTROL SYSTEMS



MODEL NO. DESIGNATION



Example: DLA-12-5-A-50-IP65

● C = customizations are offered on demand even for smaller quantities. Typical customizations indicated with green dot at column end. Please contact us for any customization request

ACTUATOR DATA						C
Reduction	5	10	20	30	40	
Voltage (VDC)	12 24	12 24	12 24	12 24	12 24	●
Current at nominal dynamic load (A)	2.0 1.0	2.4 1.2	2.6 1.3	2.9 1.5	2.8 1.4	
Nominal dynamic load (N)	150	250	500	800	1000	
Max. static load (N)	500	2500	2500	2500	2500	
Speed at nominal dynamic load (mm/s)	36.5	23.5	12.3	7.5	5.5	

ACTUATOR STROKE DATA								C
Stroke length B (mm)	25.4	50.0	100.0	150.0	200.0	250.0	300.0	●
Retracted length A (mm)	132.6	158.0	209.0	260.0	311.0	362.0	413.0	●
Life time number single strokes	157.000	80.000	40.000	26.666	20.000	16.000	13.333	
Weight (kg)	0.800	0.850	0.925	0.990	1.060	1.130	1.200	

MOTOR WIRING C

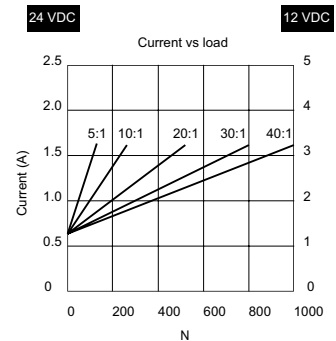
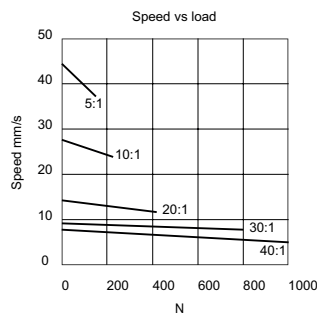
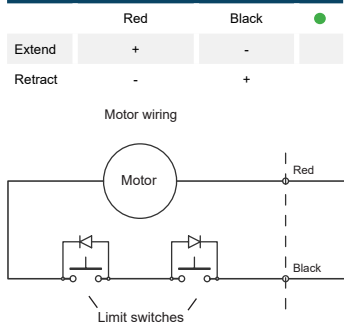

ACTUATOR FEATURES AND STANDARD DATA

Type	Electric linear actuator	
Voltage	12 or 24 VDC	●
Limit switches	Integrated non adjustable	
Feedback options	Potentiometer or hall sensor	●
Protection class	IP65	●
Duty cycle	25%	
Max. duty operational time	1 min. nominal dynamic load	
Noise level	< 70 dB (A)	●
Life time	4 million mm total stroke	
Direction movement	By reversing voltage polarity	
RoHS compliance	Yes	
CE label	Yes	

ACTUATOR FEATURES AND STANDARD DATA

Operating and storage temperature	-26°C~+65°C	
Max. motor winding temp.	155 °C	
Stroke tolerance	±3 mm	●
Screw type	ACME pitch 3 mm	
Gear material	Metal spur gears	
Motor pinion gear	Plastic	●
Cable	Flying wire 900 mm	●
Rod material	Aluminium	
House material	Aluminium	
Gear house material	STKM11A & zinc alloy	
Manufacturing quality standards	ISO 9001:2008	
EMC	EN55014 IEC61000	

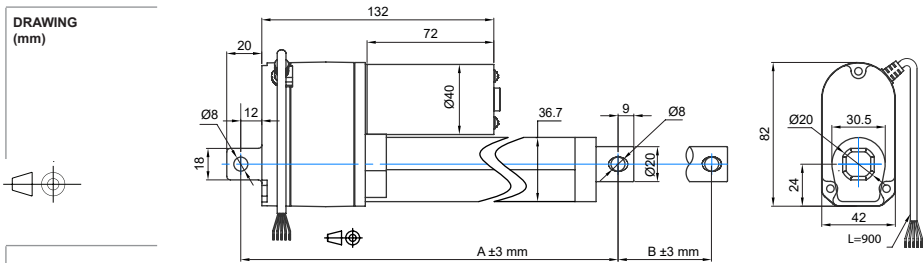

MODEL NO. DESIGNATION

DLA - VOLTAGE - REDUCTION - A - STROKE - IP65

Example: DLA-12-5-A-50-IP65

● C = customizations are offered on demand even for smaller quantities. Typical customizations indicated with green dot at column end. Please contact us for any customization request

ACTUATOR DATA						C
Reduction	5	10	20	30	40	
Voltage (VDC)	12 24	12 24	12 24	12 24	12 24	●
Current at nominal dynamic load (A)	2.0 1.0	2.4 1.2	2.6 1.3	2.9 1.5	2.8 1.4	
Nominal dynamic load (N)	150	250	500	800	1000	
Max. static load (N)	500	2500	2500	2500	2500	
Speed at nominal dynamic load (mm s)	36.5	23.5	12.3	7.5	5.5	

ACTUATOR STROKE DATA								C
Stroke length B (mm)	25.4	50.0	100.0	150.0	200.0	250.0	300.0	●
Retracted length A (mm)	169.6	195.0	246.0	297.0	348.0	399.0	450.0	●
Resistance (kΩ)	0.3 - 4.62	0.3 - 9.3	0.3 - 9.7	0.3 - 8.6	0.3 - 9.6	0.3 - 9.3	0.3 - 9.3	●
Feedback (Ω/mm)	180	180	95	55	46	36	30	●
Life time number single strokes	157.000	80.000	40.000	26.666	20.000	16.000	13.333	
Weight (kg)	0.925	1.110	1.175	1.250	1.315	1.385	1.455	

POTENTIOMETER FEATURES AND DATA		C
Type	Bourns 3590 - 10K	
Resistance	0.3 - 9.7 kΩ	●
Resolution	0.025%	
Resistance tolerance	±5%	
Linearity	±0.25%	
Cable	3+2 wires flying wire 900 mm	

MOTOR WIRING		C
	Red	Black
Extend	+	-
Retract	-	+

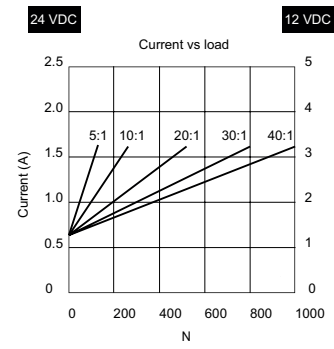
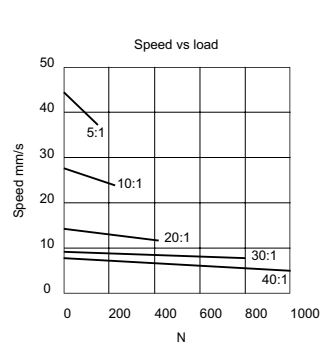
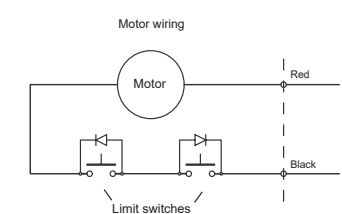
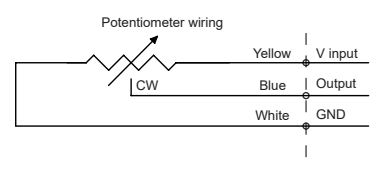

ACTUATOR FEATURES AND STANDARD DATA		
Type	Electric linear actuator	
Voltage	12 or 24 VDC	●
Limit switches	Integrated non adjustable	
Feedback options	Potentiometer or hall sensor	●
Protection class	IP65	●
Duty cycle	25%	
Max. duty operational time	1 min. nominal dynamic load	
Noise level	< 70 dB (A)	●
Life time	4 million mm total stroke	
Direction movement	By reversing voltage polarity	
RoHS compliance	Yes	
CE label	Yes	

ACTUATOR FEATURES AND STANDARD DATA		
Operating and storage temperature	-26°C~+65°C	
Max. motor winding temp.	155 °C	
Stroke tolerance	±3 mm	●
Screw type	ACME pitch 3 mm	
Gear material	Metal spur gears	
Motor pinion gear	Plastic	●
Cable	Flying wire 900 mm	●
Rod material	Aluminium	
House material	Aluminium	
Gear house material	STKM11A & zinc alloy	
Manufacturing quality standards	ISO 9001:2008	
EMC	EN55014 IEC61000	

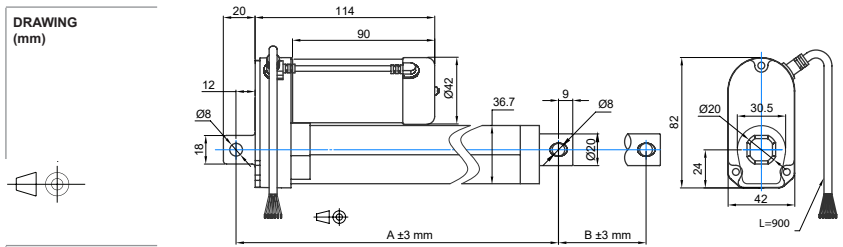

MODEL NO. DESIGNATION

DLA - VOLTAGE - REDUCTION - A - STROKE - IP65

Example: DLA-12-5-A-50-IP65

● C = customizations are offered on demand even for smaller quantities. Typical customizations indicated with green dot at column end. Please contact us for any customization request

ACTUATOR DATA						C
Reduction	5	10	20	30	40	
Voltage (VDC)	12 24	12 24	12 24	12 24	12 24	●
Current at nominal dynamic load (A)	2.0 1.0	2.4 1.2	2.6 1.3	2.9 1.5	2.8 1.4	
Nominal dynamic load (N)	150	250	500	800	1000	
Max. static load (N)	500	2500	2500	2500	2500	
Speed at nominal dynamic load (mm s)	36.5	23.5	12.3	7.5	5.5	
Number of encoder channels	2	2	2	2	2	
Hall sensor channel counts per mm	4.6	7.2	13.8	21.2	28.6	

ACTUATOR STROKE DATA							C	
Stroke length B (mm)	25.4	50.0	100.0	150.0	200.0	250.0	300.0	●
Retracted length A (mm)	132.6	158.0	209.0	260.0	311.0	362.0	413.0	●
Life time number single strokes	157.000	80.000	40.000	26.666	20.000	16.000	13.333	
Weight (kg)	0.800	0.850	0.925	0.990	1.060	1.130	1.200	

HALL SENSOR FEATURES AND DATA

Type model: **ATS177**

Supply voltage, Vcc	3.5V to 20V
Supply Current, Icc	Vcc = 20V Output open ≤10 mA
Output current, Ic	≤25 mA
Output saturation voltage, Vce(sat)	Vcc=14V ; Ic=20mA ≤ 700mV
Output leakage current, Icx	Vcc= 14V, Vce=14V ≤10 µA
Output rise and fall time, tr/f	RL=820Ω; CL=20pF ≤1,5 µS

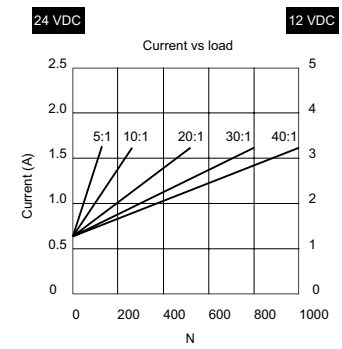
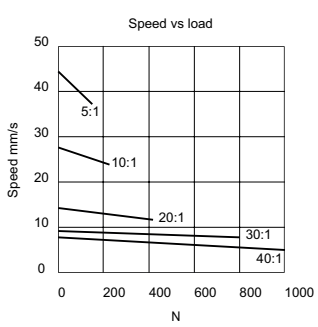
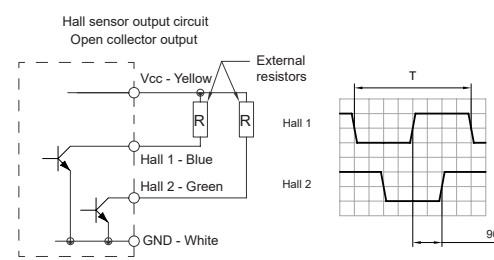

MOTOR WIRING

	Red	Black	●
Extend	+	-	
Retract	-	+	

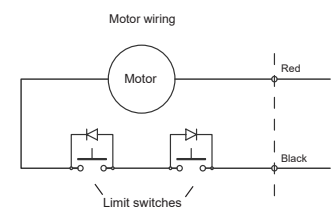

ACTUATOR FEATURES AND STANDARD DATA

Type	Electric linear actuator	
Voltage	12 or 24 VDC	●
Limit switches	Integrated non adjustable	
Feedback options	Potentiometer or hall sensor	●
Protection class	IP65	●
Duty cycle	25%	
Max. duty operational time	1 min. nominal dynamic load	
Noise level	< 70 dB (A)	●
Life time	4 million mm total stroke	
Direction movement	By reversing voltage polarity	
RoHS compliance	Yes	
CE label	Yes	

ACTUATOR FEATURES AND STANDARD DATA

Operating and storage temperature	-26°C~+65°C	
Max. motor winding temp.	155 °C	
Stroke tolerance	±3 mm	●
Screw type	ACME pitch 3 mm	
Gear material	Metal spur gears	
Motor pinion gear	Plastic	●
Cable	Flying wire 900 mm	●
Rod material	Aluminium	
House material	Aluminium	
Gear house material	STKM11A & zinc alloy	
Manufacturing quality standards	ISO 9001:2008	
EMC	EN55014 IEC61000	